

Samputensili

INTRODUCES
HIGH CAPACITY
GRINDING MACHINE



The new S 250G generating grinding machine from Samputensili, introduced at EMO 2005, was developed to achieve a shorter cycle time.

According to the company's press release, the vertical grinding machine combines the strength and stability of hobbing machines with the precision and flexibility of grinding machines. This machine is suitable for virtually any production environment.

Features include a machine bed made of cast iron. The subassembly carrying the grinding spindle is constructed of light metal and runs on anti-friction guideways. Shifting is performed by a ballscrew spindle. Absolute precision of movement is ensured by the sub-assembly, which consists of the spindle with the electric drive, absolute position

encoder and tailstock. The spindle offers an output of 48 kW, a maximum speed of 2,000 rpm, and can be equipped with temperature sensors and position measuring systems for real-time control of its function to permit adjustments as necessary. Synchronization between the tool and workpiece is ensured by the Siemens CNC control system as well as a magnetic encoder with resolution in the thousandths of an inch. In addition, the stream of coolant is constantly adjusted to the tool diameter and aligned to the point of contact between the tool and workpiece, which varies depending on the wear of the tool.

The machine is equipped with a modular gantry loader that allows the S 250G to be directly incorporated in existing production lines. No other devices are required for handling of the

workpieces. To reduce the ancillary and auxiliary process times of the machines to a minimum, centering (stock division) takes place outside the work area before the workpieces are positioned on the workpiece spindle and while grinding is taking place on the machine. ■

For more information:

Star SU LLC
5200 Prairie Stone Pkwy., Suite 100
Hoffman Estates, IL 60192
Phone: (847) 649-1450
Fax: (847) 649-0112
E-mail: sales@star-su.com
Internet: www.star-su.com

Austempering— When “Strong As Steel” Isn’t Strong Enough



For Stronger High-Performance Parts, We Turn Up The Heat

Extreme performance applications require extreme strength. Let Applied Process show you how Carbo-Austempering™ can make your steel components stronger, tougher and longer lasting under extreme conditions. We're the leader in austempering technology with 30 years of research, development and production experience.

Contact Applied Process today.
Put our strength to the test.



APPLIED PROCESS SM INC
www.appliedprocess.com

Tel: (734) 464-8000

Michigan Wisconsin Kentucky
Australia England British Columbia

PRODUCT NEWS

Klüber's

NEW DISPENSER
ALLOWS FOR MORE
ACCURATE DISPENSING



The Klübermatic FG lubricant dispenser allows for hygienic and accurate dispensing of lubricating grease to machinery in the food and pharmaceutical industries without risk of contamination. The dispenser can be mounted over numerous machine elements, including rolling and plain bearings, open gears and guideways.

According to the company's press release, the FG lets users decide how much lubricant is distributed. Depending on the type of activating screw inserted, an operator can deliver 100 cm³ of lubricant in either one, three or six months.

Constructed entirely of plastic and other corrosion-resistant materials, the dispenser is suitable for use in wet production areas or underwater. ■

For more information:

Klüber Lubrication
32 Industrial Dr.
Londonderry, NH 03053
Phone: (603) 641-4104
E-mail: info@us.kluber.com
Internet: www.kluber.com

Why Grinding... ...when you can Fässler Hone?

HMX-400



**Visit us at Gear Expo 2005
Booth # 100**

Fässler Corporation · 131 W. Layton Avenue, Suite 308 · Milwaukee, WI 53207
Phone +1 (414) 769-0072 · Fax +1 (414) 769-8610 · E-mail: usa@faessler-ag.ch

Fässler
Customised solutions

www.faessler-ag.ch



Ticona's

NEW SULFIDE MATERIAL MAKES BRAKING EASIER

Fortron linear polyphenylene sulfide (PPS) has been used for actuator housings and gears to help transfer power from the actuator motor to the brakes.

Fortron PPS, manufactured by Ticona, has worked in actuators of rear wheels, like those found in Volkswagen, Bentley, Bugatti and Lancia automobiles, because of the material's dimensional stability across a wide temperature range as well as its impact resistance, chemical resistance and processability.

According to the company's press release, each PPS actuator is comprised of an injection molded body and cover. The two components are ultrasonically welded to create the final assembly. The PPS spur gear within the actuator has a diameter of about 30 mm and is driven by a belt from an electric motor. The

gear then drives a transmission that actuates the brake.

The key requirement that led to the selection of Fortron PPS in the actuator is its ability to remain dimensionally stable at temperatures from well below 0° to 180°C. It also can withstand the impact of stones thrown up by tires from the road surface and has excellent resistance to brake fluid and other automotive chemicals. The PPS also flows in molding to create low flash parts, eliminating the need for secondary finishing steps for the gears. ■

For more information:
Ticona Technical Polymers
8040 Dixie Hwy.
Florence, KY 41042
Phone: (800) 833-4882
E-mail: infoservice@ticona.de
Internet: www.ticonaservice.de

Technotrade

OFFERS NEW METAL COATING STRIPPERS

The new Deconex® line of strippers for soak bath processes from Technotrade remove TiN, TiCN, CrN and TiAlN multilayer coatings from carbides, carbide composites, and tool steels without damaging the base material.

According to the company's press release, the strippers are chemically formulated to strip specific coatings from specific substrates in cold- or hot-process baths, depending upon formulation. Developed to protect the integrity of the base material and extend tool life, they permit re-coating of TiN, TiCN, CrN and TiAlN-multilayer coatings on carbides, composites of carbides, high speed steels (HSS), P/M steels and other tool steels.

Allowing tool and high-wear parts to be recoated several times, the metal coating strippers have a 3–5% dilution. Applications include forming tools, drill bits, end mills, hobs, cutting inserts, pins, punches, bushings and other wear parts. ■

For more information:
Technotrade International
7 Perimeter Rd.
Manchester, NH 03103-3343
Phone: (603) 622-5011
Internet: www.technotradeinc.com



WENZEL

Gear Tec

*New Solutions in
Gear Metrology...*



WGT350 or 500

*Fast and intelligent gear measurement
Full range of machine sizes to 2,000mm diameter
Air bearings on all linear and rotary axes
Solid granite construction provides optimum stability
User-friendly Windows-based software
More than just gear measurement*

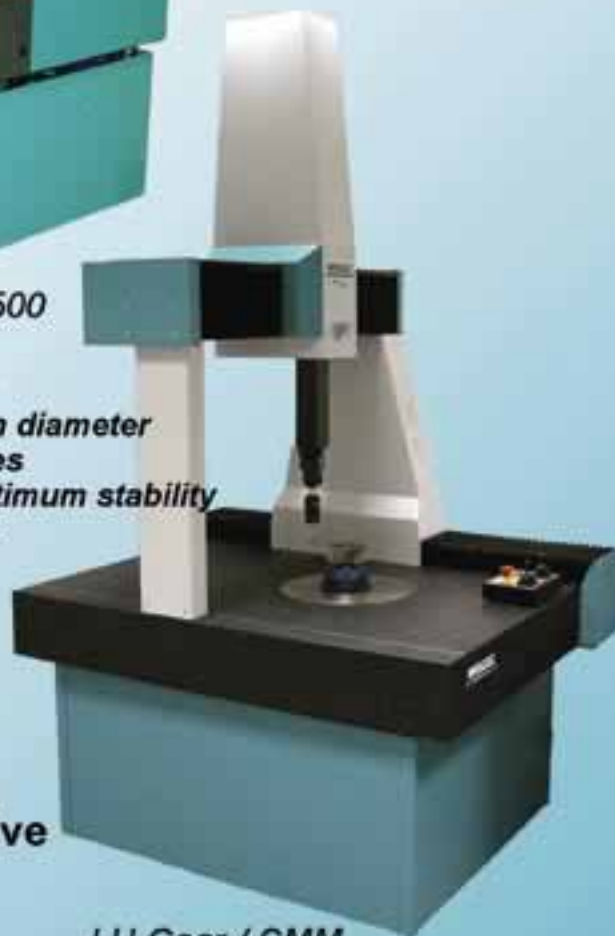

LH Gear / CMM

**Koepfer America, LLC
North-American Representative**

635 Schneider Drive
South Elgin, IL 60177
847.931.4121 telephone
847.931.4192 fax
www.koepferamerica.com
sales@koepferamerica.com



KOEPPER

Member of



Visit us at AGMA Gear Expo 2005!

Rugged, Reliable, Repeatable ...For 75 Years!

- Applicable to Spur and Helical Gears!
- Gage the Part at the Machine!

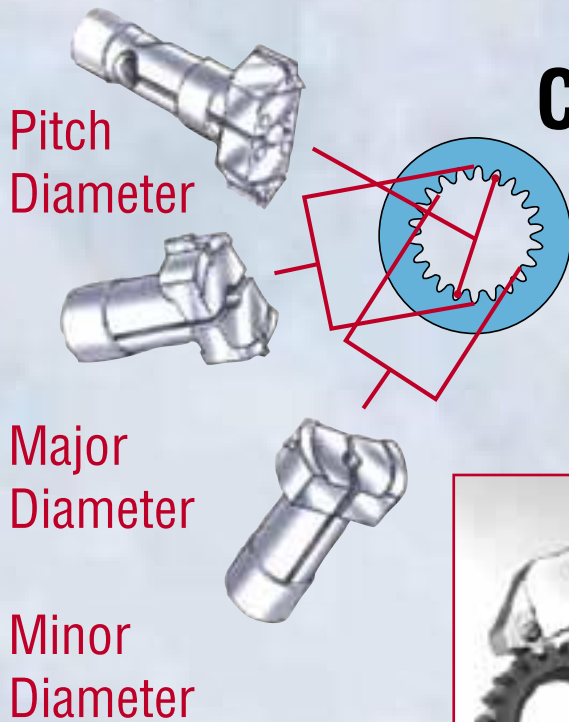

COMTOR SPLINE GAGES



Internal or
External Spline
Measurement
Made Easy!

*Still using micrometers
and pins method?*

*Comtor Spline Gages
make pitch diameter
measurement quick,
easy and accurate!*

comtorgage®

Comtorgage Corporation
(since 1928)

Phone: (401) 765-0900 • Fax (401) 765-2846

www.comtorgage.com

Sumitomo Drive

INTRODUCES
GEARBOXES FOR
POWER TRANSMISSION
APPLICATIONS

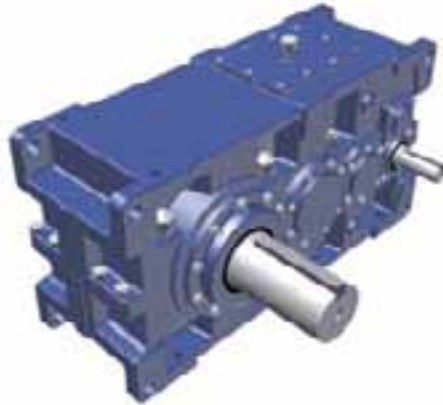

The new Paramax 9000 gearboxes from Sumitomo Drive Technologies are designed for demanding industrial power transmission applications.

According to the company's press release, the gearboxes offer torque capacities up to 600,000 N-m and ratios up to 500:1 for applications involving materials handling, mining and quarrying, cranes, extruders, agitators and mixers, cooling tower drives, sugar processing and forestry equipment.

The design features gears that have a helix angle increased to 14°, resulting in a higher number of teeth in contact. A 25° pressure angle ensures greater tooth strength, making the gears suitable for high overload applications.

Optimized gears are enclosed in a universal cast iron or optical ductile and fabricated housing, which accommodates both right- and left-hand applications and horizontal, vertical and upright mounting. Housings are

rugged to minimize deflection under load and also allow reduced entry-way widths and space consolidation. ■

For more information:

Sumitomo Machinery Corp.
4200 Holland Blvd.
Chesapeake, VA 23322
Phone: (888) 874-5800
Internet: www.suminet.com



B&R Visit us at Gear Expo 2005
Booth #516

Machine and Gear Corporation

CUSTOM BEVEL GEAR MANUFACTURING
PER YOUR SPECIFICATIONS AND/OR SAMPLE
PROVIDING INVERSE ENGINEERING TO MAKE A CLONE OF YOUR SAMPLE

- SPIRAL BEVEL GEARS: 66" PD
- STRAIGHT BEVEL GEARS: 80" PD
- SPURS-HELICALS-SPLINE SHAFTS
- GEARBOX REPAIR/REBUILDS
- IN-HOUSE STEEL MATERIAL WAREHOUSE
- FULL HEAT TREATING SERVICES
- EDM WIRE BURNING

BREAKDOWN SERVICES

4809 U.S. HIGHWAY 45 • SHARON, TN 38255
TOLL FREE: (800)-238-0651 • PHONE: (731)-456-2636 • FAX: (731)-456-3073
EMAIL: inquiry@brgear.com • www.brgear.com

MEMBER OF

Family owned and operated since 1974

Harmonic Drive

INTRODUCES NEW GEARHEADS

Harmonic Drive Technologies introduced its RGH Series of compact gearheads that offer the accuracy and repeatability typically associated with harmonic drive gearing in a more compact design than traditional, high ratio gearheads, according to the company's press release.

RGH gearheads combine zero backlash gear components with an integral flange output supported by heavy duty bearings, allowing units to provide

high axial, radial and moment loads for their compact size. Available in four sizes with a rated output torque from 221–1,212 in.-lbs. and maximum output torques up to 6,072 in.-lbs. Positional accuracy of the gearheads is less than one arc minute and reduction ratios are available from 50:1–160:1. The gearheads are easily mounted to most servo motors and are suitable for applications requiring precise positional accuracy and repeatability, including robots, positioning systems and factory automation equipment. ■

For more information:
Harmonic Drive Technologies
247 Lynnfield St.
Peabody, MA 01960
Phone: (978) 532-1800
Internet: www.harmonic-drive.com



Midwest Motion

INTRODUCES NEW GEARMOTOR



The new MMP-TM55-24V GP52-046 gearmotor from Midwest Motion accepts any 24 volt DC source, including battery power.

According to the company's press release, the gearmotor measures 2.14" in diameter by 7.25" long and has a keyed output shaft of 12 mm diameter by 25 mm long. Four "face mount" M5 threaded holes that are equally spaced on a 40 mm diameter bolt circle facilitate easier mounting.

The output of the gearmotor is rated for 5.2 Nm continuous torque at 100 rpm and 8.0 Nm peak. The motor requires 3.5 ampere at 24 volts DC to generate full load output torque. Optional 12 and 36 volt windings are available. The design is rated at IP 54 protection level for operation in harsh environments.

Options include integral optical encoders, failsafe brakes, analog tachometers and planetary gearheads with standard ratios from 3:1 to 450:1 with standard or low backlash precision gearing available. ■

For more information:
Midwest Motion Products
10961 Ahern Ave. SE
Watertown, MN 55388
Phone: (952) 955-2626
Internet: www.midwestmotion.com